

ROHS

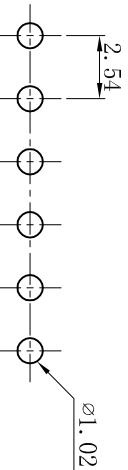
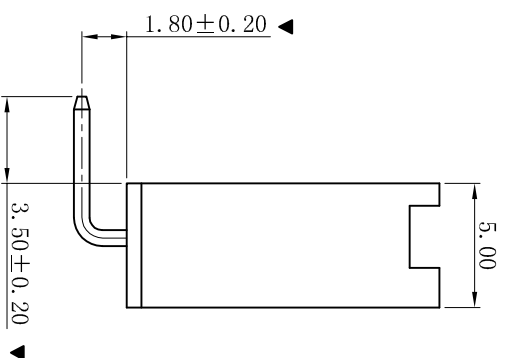
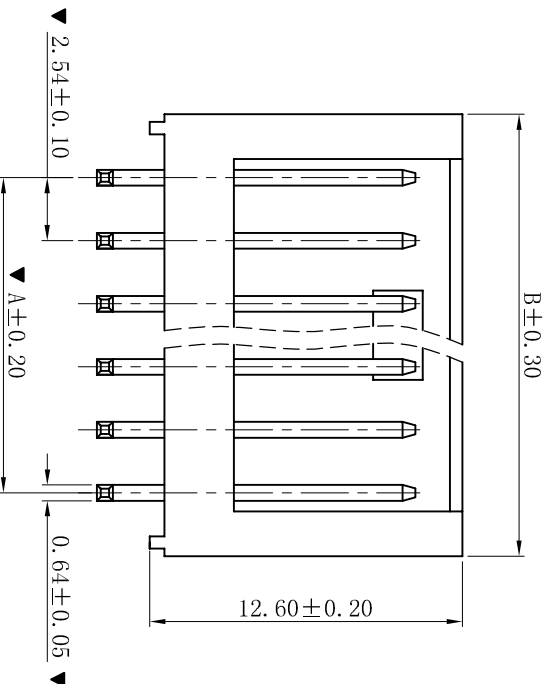
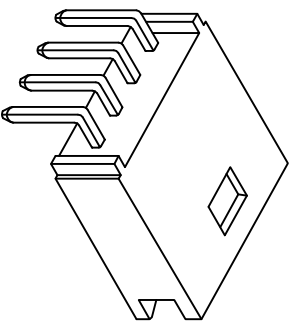
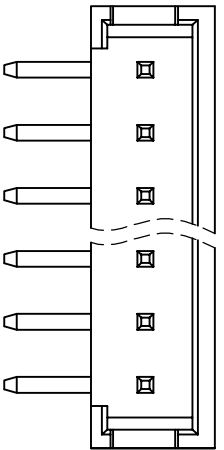

P. C. B LAYOUT

■ SPECIFICATIONS

- Voltage rating: 250V AC, DC
- Current rating: 3A, AC, DC
- Withstanding Voltage: 1000V AC/minute
- Insulation resistance: 1000MΩ min
- Temperature range: -25° C ~ +85° C
- Contact resistance: 20mΩ max

■ WAFER

- Part No. : W2543R-NP
- Poles : 02-22P
- Housing Material : PA66 UL94V-2 Black
- Pin Material : Brass
- Contact Area Plating : Tin-Plated
- The Dimension Marked “▼” Must Be Recorded

Poles	Dimensions (mm)	
	A	B
02	2.54	7.70
03	5.08	10.20
04	7.62	12.70
05	10.16	15.20
06	12.70	17.80
07	15.24	20.30
08	17.78	22.90
09	20.32	25.40
10	22.86	28.00
11	25.40	30.50
12	27.94	33.10
13	30.48	35.60
14	33.02	38.10
15	35.56	40.70
16	38.10	43.20
17	40.64	45.70
18	43.18	48.20
19	45.72	50.70
20	48.26	53.20
21	50.80	55.70
22	53.34	58.50

D	更新图面	2019-06-03	陈雄军	一般公差 GENERAL TOLERANCE:	0±0.30 .0±0.25 .000±0.05
C	修订版本	2015-11-04	陈雄军	ANGLE: ±1°	
B	变更图宽格式内容	2013-12-27	陈雄军	绘图/DR	陈雄军
A	新版本	2011-05-24	陈雄军	审核/CHECK	胡进
H	版次 REV.	说明 DESCRIPTION	日期 DATE	承认 APPRO.	日期/DATE
1					2019-06-03

**XYDZ® 东莞市祥运连接器有限公司**  
Dongguan XiangYun Connectors CO., Ltd

投影法 Projection	品名 (PART NAME)	AMP 2.54mm 90° Wafer Connector Series
单位 Unit	料号 (PART NO)	W2543R-NP
比例/Scale	状态码	C
大小/Size		
页码/Sheet		
版本/Rev		