

RoHS

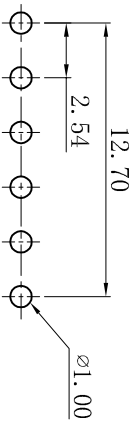
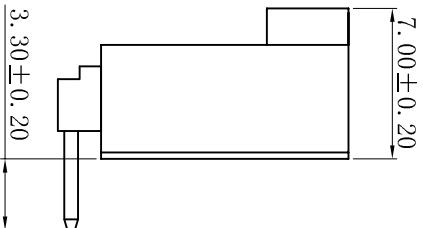
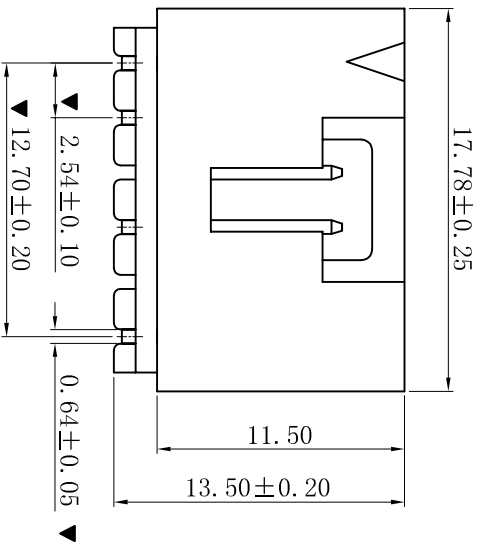
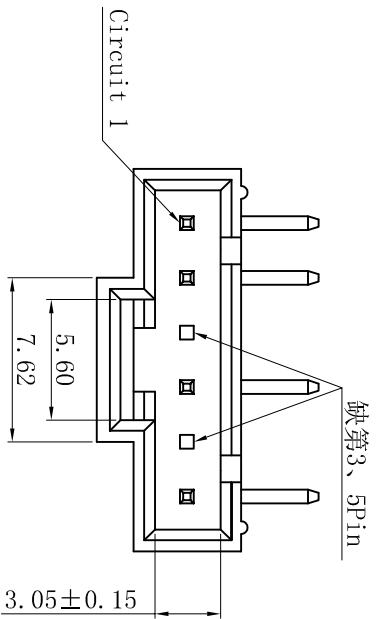

P. C. B LAYOUT

- SPECIFICATIONS
- Voltage rating: 250V AC, DC
 - Current rating: 5A, AC, DC
 - Withstanding Voltage: 1500V AC/minute
 - Insulation resistance: 1000MΩ min
 - Temperature range: -25° C~+85° C
 - Contact resistance: 20mΩ max

■ WAFER

- Part No. : W2545R-06P-Q2P
- Poles : 06P
- Housing Material : PA66 15%GF UL94V-0 Black
- Pin Material : Brass
- Contact Area Plating: Gold-Flash
- The Dimension Marked “▼” Must Be Recorded

D	更新图面	2019-06-03	陈雄军
C	修订版本	2015-11-04	陈雄军
B	变更图宽格式内容	2013-12-27	陈雄军
A	新版本	2011-05-24	陈雄军
H	说明	日期	承认
1	版次	REV.	APPRO.

一般公差	0±0.30
GENERAL TOLERANCE:	.0±0.25
	.00±0.20
	.000±0.05
ANGLE: ±1°	
绘图/DR	陈雄军
审核/CHECK	陈雄军
核准/APPRO	胡进
日期/DATE	2019-06-03

XYDZ® 东莞市祥运连接器有限公司
 Dongguan XiangYun Connectors CO., Ltd

投影法 Projection	品名 (PART NAME)	Mollex 2.54mm 90° Wafer Connector Series
单位 Unit MM	料号 (PART NO)	W2545R-06P-Q2P
比例/Scale 1:1	页码/SHEET 1/1	版本号 Rev
大小/Size A4		

1 2 3 4 5 6 7 8 9 10