

ROHS

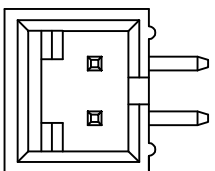
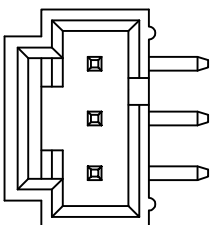
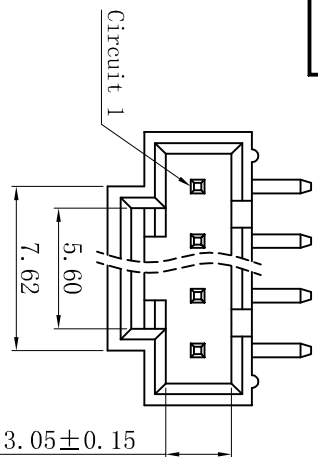

3 Poles

2 Poles

■ SPECIFICATIONS

- Voltage rating: 250V AC, DC
- Current rating: 5A, AC, DC
- Withstanding Voltage: 1500V AC/minute
- Insulation resistance: 1000MΩ min
- Temperature range: -25° C~+85° C
- Contact resistance: 20mΩ max

■ WAFER

- Part No.: W2545R-NP-WL2.45-H
- Poles : 02-20P
- Housing Material: PA66 15%GF UL94V-0 Black
- Pin Material: Brass
- Contact Area Plating: Gold-Flash
- The Dimension Marked “▼” Must Be Recorded
- PIN L=0.64x14.20mm

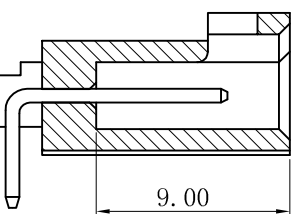
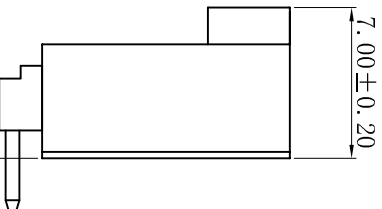
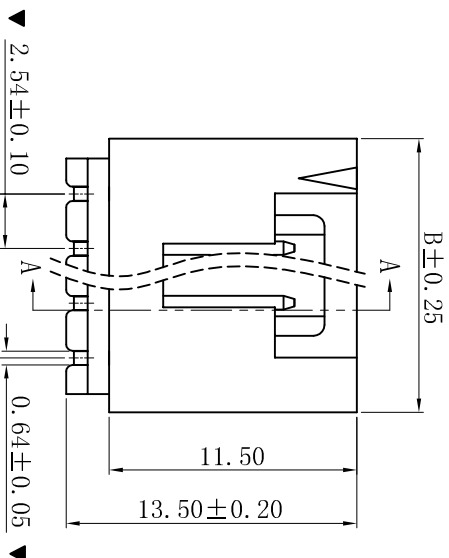

SECTION: A-A

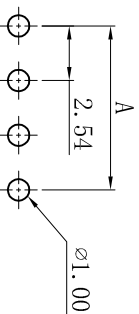

P. C. B LAYOUT

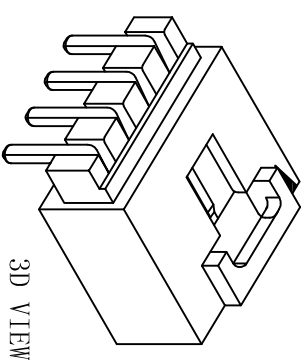

3D VIEW

Poles	Dimension (mm)	
	A	B
02	2.54	7.62
03	5.08	10.16
04	7.62	12.70
05	10.16	15.24
06	12.70	17.78
07	15.24	20.32
08	17.78	22.86
09	20.32	25.40
10	22.86	27.94
11	25.40	30.48
12	27.94	33.02
13	30.48	35.56
14	33.02	38.10
15	35.56	40.64
16	38.10	43.18
17	40.64	45.72
18	43.18	48.26
19	45.72	50.80
20	48.26	53.34

D	更新图面	2019-06-03	陈雄军	一般公差 GENERAL TOLERANCE: 0±0.30 .0±0.25 .00±0.20 .000±0.05 ANGLE: ±1°
C	修订版本	2015-11-04	陈雄军	绘图/DR P.C. Draw
B	变更图宽格式内容	2013-12-27	陈雄军	审核/CHECK 陈雄军
A	新版本	2011-05-24	陈雄军	批准/APPRO 胡进
H	版次 REV.	1	说明 DESCRIPTION	日期 DATE: 2019-06-03

<p>XYDZ® 东莞市祥运连接器有限公司 Dongguan XiangYun Connectors CO., Ltd</p>	
<p>投影法 Projection 单位 Unit MM</p>	<p>品名 (PART NAME) Mollex 2.54mm 90° Wafer Connector Series</p>
<p>比例/Scale 大小/Size A4</p>	<p>料号 (PART NO) W2545R-NP-WL2.45-H</p>
<p>页码/SHEET 1/1</p>	<p>状态码 C</p>