

ROHS

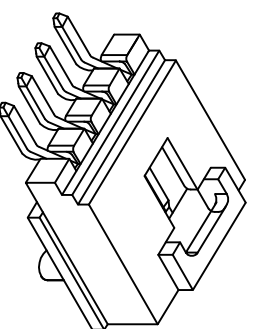

P. C. B LAYOUT

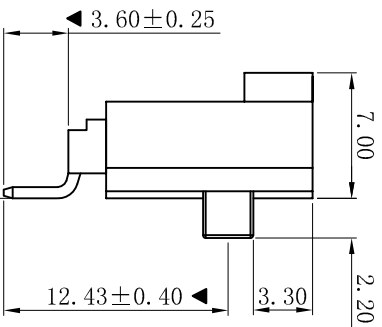
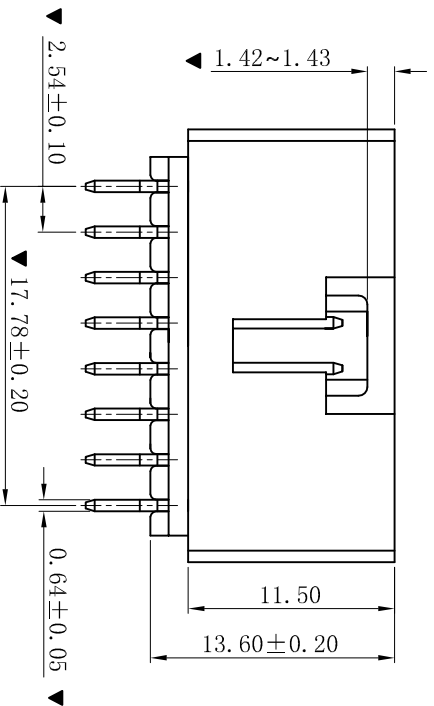
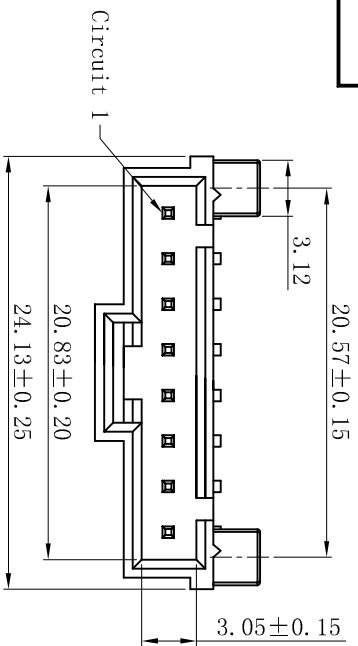
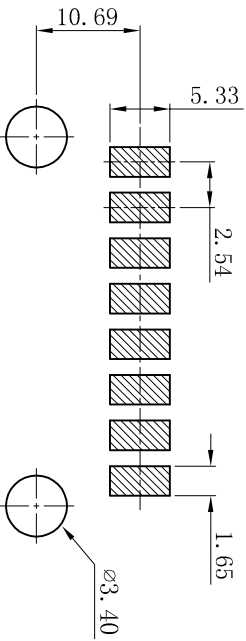

■ SPECIFICATIONS

- Voltage rating: 250V AC, DC
- Current rating: 5A, AC, DC
- Withstanding Voltage: 1500V AC/minute
- Insulation resistance: 1000MΩ min
- Temperature range: -25° C~+85° C
- Contact resistance: 20mΩ max

■ WAFER

- Part No.: W2545SR-08P-9TBK-KR
- Poles : 08P
- Housing Material : PA9T UL94V-0 Black
- Pin Material : Brass
- Contact Area Plating: Gold-Flash
- The Dimension Marked "▲" Must Be Recorded

更新图面		2019-06-03		陈雄军		一般公差 GENERAL TOLERANCE:		0±0.30 .0±0.25 .00±0.20 .000±0.05		投影法 Projection		品名 (PART NAME)		料号 (PART NO)		状态码	
修打版本		2015-11-04		陈雄军		ANGLE: ±1°				单位 Unit		Molex 2.54mm SMT 90° Wafer		W2545SR-08P-9TBK-KR		C	
变更图览格式内容		2013-12-27		陈雄军						大小/Scale		Connector Series					
新版本		2011-05-24		陈雄军						页码/SHEET							
说明		日期		承认						版本/Rev							
DESCRIPTION		DATE:		APPRO.						日期/DATE							
版次		1		1													

XYDZ® 东莞市祥运连接器有限公司
Dongguan XiangYun Connectors CO., Ltd