

ROHS

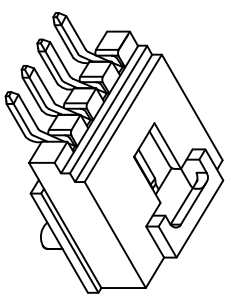
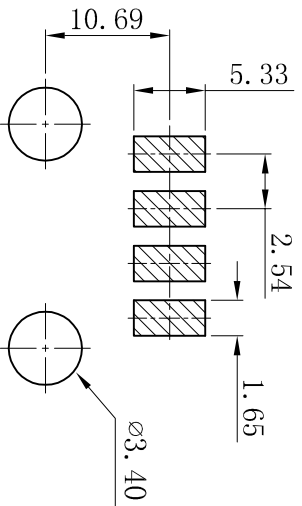
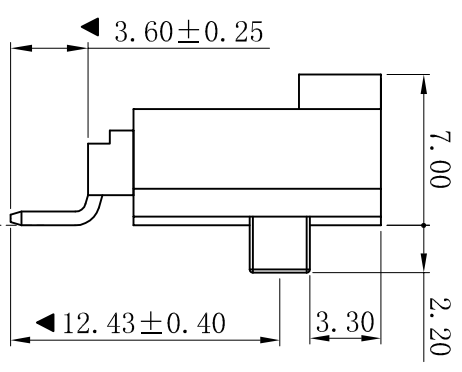
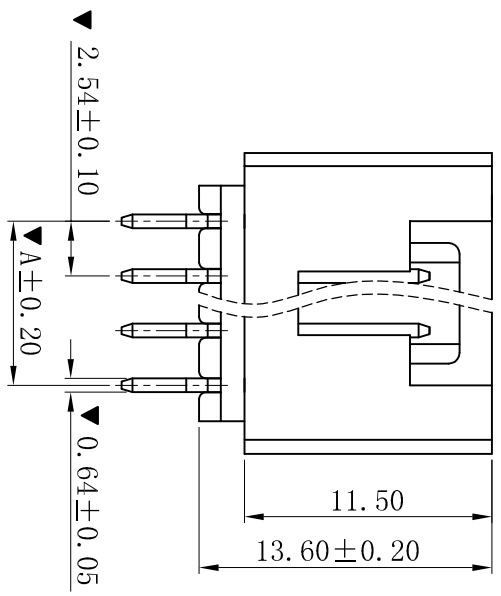
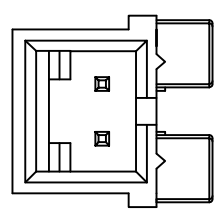
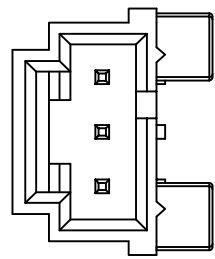
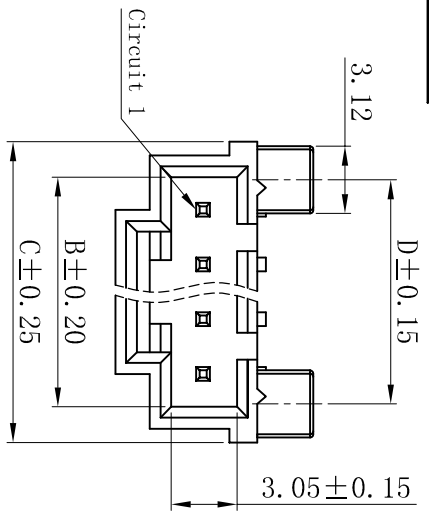

- SPECIFICATIONS
- Voltage rating: 250V AC, DC
  - Current rating: 5A, AC, DC
  - Withstanding Voltage: 1500V AC/minute
  - Insulation resistance: 1000MΩ min
  - Temperature range: -25° C~+85° C
  - Contact resistance: 20mΩ max
- WAFER
- Part No.: W2545SR-NP-91TBK
  - Poles : 02-12P
  - Housing Material: PA9T UL94V-0 Black
  - Pin Material: Brass
  - Contact Area Plating: Gold-Flash
  - The Dimension Marked “▼” Must Be Recorded

Poles	Dimensions (mm)			
	A	B	C	D
02	2.54	5.58	8.89	5.33
03	5.08	8.13	11.43	7.87
04	7.62	10.67	13.97	10.41
05	10.16	13.21	16.51	12.95
06	12.70	15.75	19.05	15.49
07	15.24	18.29	21.59	18.03
08	17.78	20.83	24.13	20.57
09	20.32	23.37	26.67	23.11
10	22.86	25.91	29.21	25.65
11	25.40	28.45	31.75	28.19
12	27.94	30.99	34.29	30.73

D	更新图面	2019-06-03	P. C. Wu
C	修打版本	2015-11-04	陈雄军
B	变更图宽格式内容	2013-12-27	陈雄军
A	新版本	2011-05-24	陈雄军
H	说明	日期	承认
REV.	DESCRIPTION	DATE	APPRO.
1			
2			
3			
4			
5			
6			
7			
8			
9			
10			

一般公差	0±0.30
GENERAL TOLERANCE:	.00±0.25
	.000±0.05
ANGLE:	±1°
绘图/DR	P. C. Wu
审核/CHECK	陈雄军
批准/APPRO	胡进
日期/DATE	2019-06-03

**XYDZ® 东莞市祥运连接器有限公司**  
Dongguan XiangYun Connectors CO., Ltd

投影法 Projection: 单位 Unit: MM 比例/Scale: 1:1 大小/Size: A4 页码/Sheet: 1/1 版本/Rev: D

品名 (PART NAME): Molex 2.54mm SWT 90° Wafer Connector Series  
料号 (PART NO): W2545SR-NP-91TBK  
状态码: C

