

RoHS

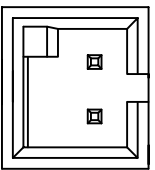

(高卡左扣)

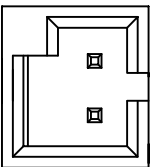

(特殊左扣)

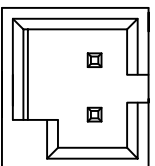

(特殊右扣)

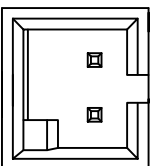

(高卡右扣)

W2545V-02P-0EZK (左扣橙色)  
 W2545V-02P-BKZK (左扣黑色)  
 W2545V-02P-WEZK (左扣白色)  
 W2545V-02P-YWZK (左扣黄色)

W2545V-02P-GNYK (右扣绿色)  
 W2545V-02P-WBYK (右扣白色)  
 W2545V-02P-BKYK (右扣黑色)

- SPECIFICATIONS
- Voltage rating: 250V AC, DC
  - Current rating: 5A, AC, DC
  - Withstanding Voltage: 1500V AC/minute
  - Insulation resistance: 1000MΩ min
  - Temperature range: -25° C~+85° C
  - Contact resistance: 20mΩ max
- WARNER
- Part No. : W2545V-02P-XXXX
  - Poles : 02P
  - Housing Material: PA66 15%GF UL94V-0
  - Pin Material: Brass
  - Contact Area Plating: Gold-Flash(0.5u" Min)
  - The Dimension Marked "▼" Must Be Recorded

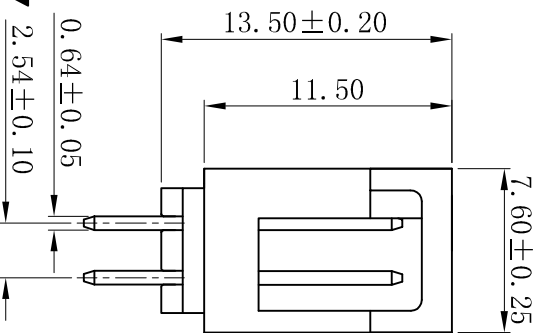

(左扣)

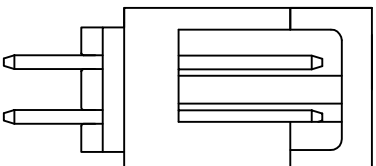

(右扣)

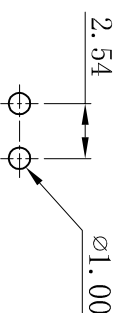

P.C.B LAYOUT

D	更新图面	2019-06-03	陈雄军
C	修订版本	2015-11-04	陈雄军
B	变更图宽格式内容	2013-12-27	陈雄军
A	新版本	2011-05-24	陈雄军
H	说明	日期	承认
1	版次	DESCRIPTION	APPRO.

一般公差	0±0.30
GENERAL TOLERANCE:	.0±0.25
	.00±0.20
	.000±0.05
ANGLE: ±1°	

XYDZ® 东莞市祥运连接器有限公司	
Connectors Dongguan XiangYun Connectors CO., Ltd	
投影法 Projection	第一角投影
单位 Unit	MM
比例/Scale	1:1
大小/Size	A4
页码/Sheet	1/1
版本/Rev	D
品名 (PART NAME)	Molex 2.54mm 180° 2P 特殊 Wafer Connector Series
料号 (PART NO)	W2545V-02P-XXXX
状态码	C