

ROHS

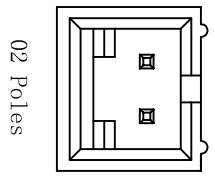
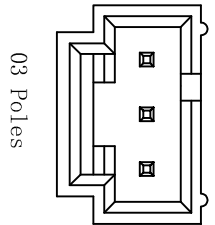
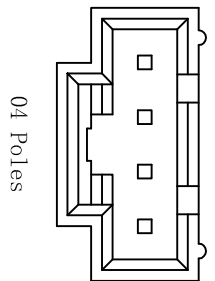
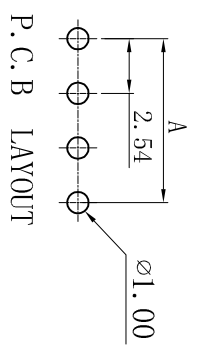
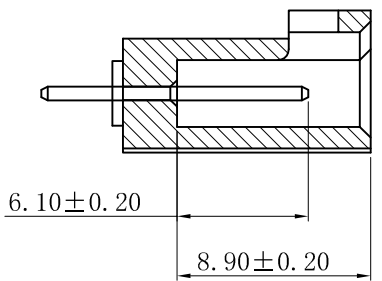
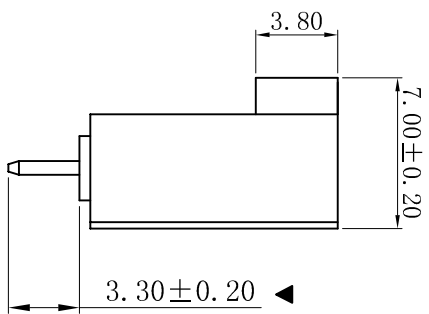
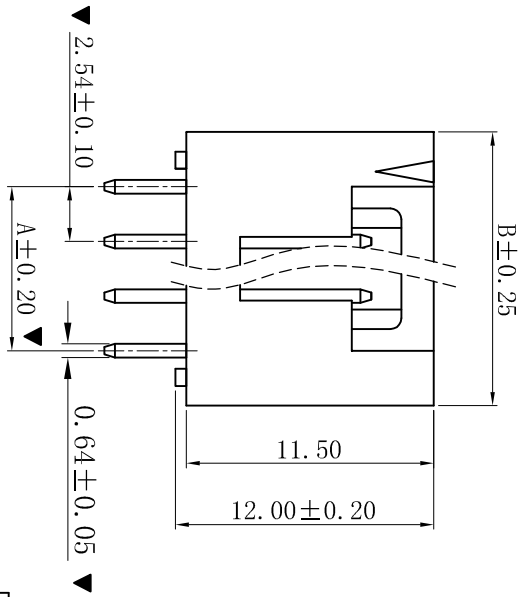
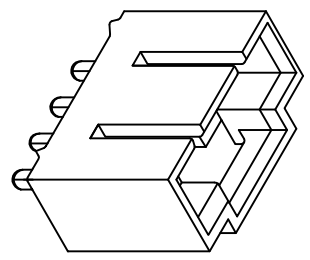
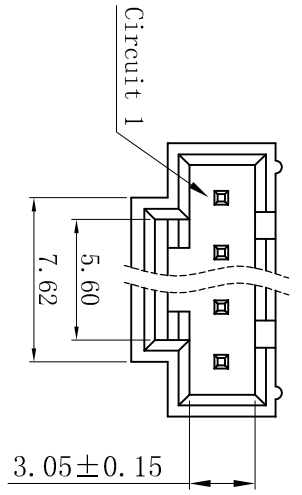

Poles	Dimension (mm)	
	A	B
02	2.54	7.62
03	5.08	10.16
04	7.62	12.70
05	10.16	15.24
06	12.70	17.78
07	15.24	20.32
08	17.78	22.86
09	20.32	25.40
10	22.86	27.94
11	25.40	30.48
12	27.94	33.02
13	30.48	35.56
14	33.02	38.10
15	35.56	40.64
16	38.10	43.18
17	40.64	45.72
18	43.18	48.26
19	45.72	50.80
20	48.26	53.34

■ SPECIFICATIONS

- Voltage rating: 250V AC, DC
- Current rating: 5A, AC, DC
- Withstanding Voltage: 1500V AC/minute
- Insulation resistance: 1000MΩ min
- Temperature range: -25°C~+85°C
- Contact resistance: 20mΩ max

■ WAFER

- Part No.: W2545V-NP-SN
- Poles : 02-20P
- Housing Material : PA66 15%GF UL94V-0 Black
- Pin Material : Brass
- Contact Area Plating: Tin-Plated
- The Dimension Marked “▼” Must Be Recorded

D	更新图面	2019-06-03	陈雄军	一般公差 GENERAL TOLERANCE:	0±0.30 .0±0.25 .00±0.20 .000±0.05	绘图/DR	陈雄军	审核/CHK	陈雄军	日期/DATE	2019-06-03
C	修订版本	2015-11-04	陈雄军	ANGLE: ±1°		投影法 Projection	MM	比例/Scale	1:1	料号 (PART NO)	W2545V-NP-SN
B	变更图宽格式内容	2013-12-27	陈雄军			单位 Unit	MM	大小/Size	A4	状态 Status	C
A	新版本	2011-05-24	陈雄军			页码/Sheet	1/1	版本/Rev	D		
H	说明	DESCRPTION	承认								
1	版次	REV.									

XYDZ® 东莞市祥运连接器有限公司  
Dongguan XiangYun Connectors CO., Ltd

Molex 2.54mm 180° Wafer  
Connector Series