

ROHS

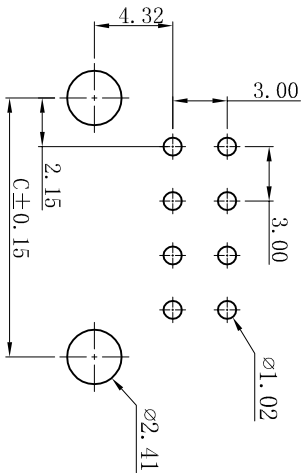
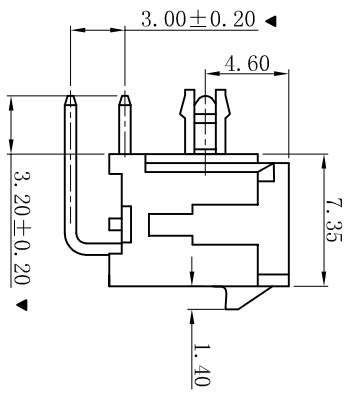
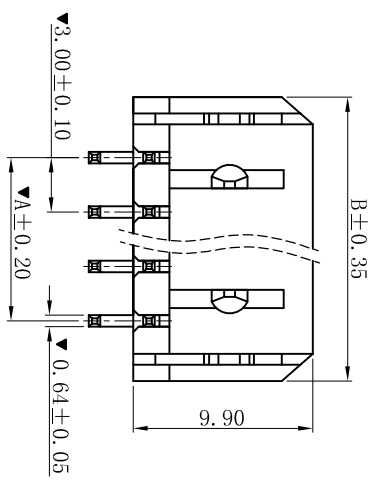
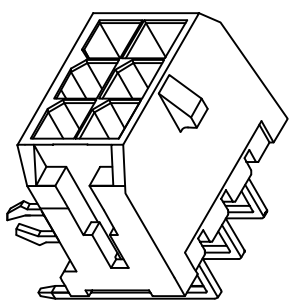
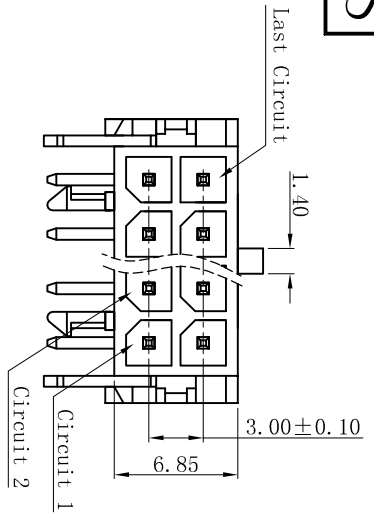

P. C. B. LAYOUT

■ SPECIFICATIONS

- Voltage rating: 250V AC, DC
- Current rating: 5A, AC, DC
- Withstanding Voltage: 1500V AC/minute
- Insulation resistance: 1000MΩ min
- Temperature range: -25° C ~ +85° C
- Contact resistance: 20mΩ max

■ WAFER

- Part No. : W3045RDD-2xNP
- Poles : 02-24P
- Housing Material : PA66 15%GF UL94V-0 Black
- Pin Material : Brass
- Ter Material : Brass
- Contact Area Plating : Tin-plated
- The Dimension Marked "▲" Must Be Recorded

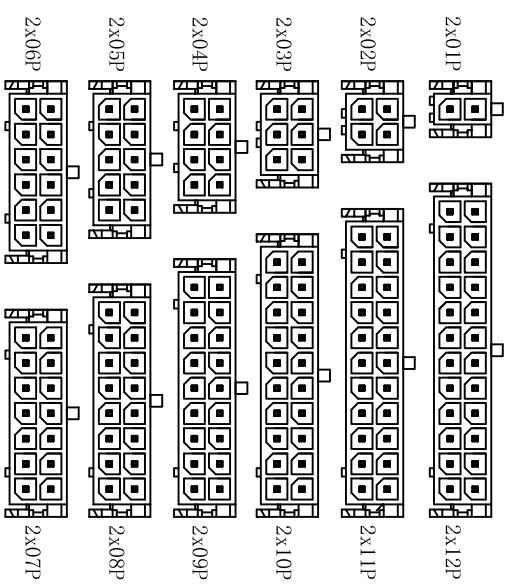

CIRCUIT SIZE LAYOUT

Poles	Dimensions (mm)		
	A	B	C
2x01	--	6.65	4.30
2x02	3.00	9.65	7.30
2x03	6.00	12.65	10.30
2x04	9.00	15.65	13.30
2x05	12.00	18.65	16.30
2x06	15.00	21.65	19.30
2x07	18.00	24.65	22.30
2x08	21.00	27.65	25.30
2x09	24.00	30.65	28.30
2x10	27.00	33.65	31.30
2x11	30.00	36.65	34.30
2x12	33.00	39.65	37.30

**XYDZ® 东莞市祥运连接器有限公司**  
 Dongguan XiangYun Connectors CO., Ltd

一般公差 GENERAL TOLERANCE:	0±0.30 .0±0.25 .000±0.20 ANGLE: ±1°
绘图/DR	陈雄军
审核/CHECK	陈雄军
批准/APPRO	胡进
日期/DATE	2019-06-03

投影法 Projection:   
 单位 Unit: MM  
 比例/Scale: 1:1  
 大小/Size: A4  
 页码/SHEET: 1/1  
 版本/Rev: D

品名 (PART NAME): Molex 3.0mm DIP 90° 鱼叉式  
 (PART NAME): Wafer Connector Series

料号 (PART NO): W3045RDD-2xNP  
 状态码: C

D	更新图画	2019-06-03	陈雄军	更新图画						
C	修打版本	2015-11-04	陈雄军	修打版本						
B	变更图画格式内容	2013-12-27	陈雄军	变更图画格式内容						
A	新版本	2011-05-24	陈雄军	新版本						
H	版次 REV.	说明 DESCRIPTION	日期 DATE	承认 APPRO.						
1	1	2	3	4	5	6	7	8	9	10