

ROHS

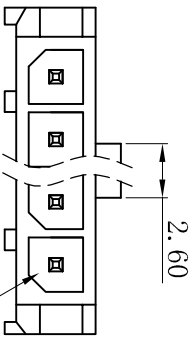

Circuit 1

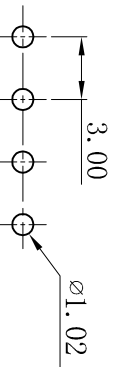
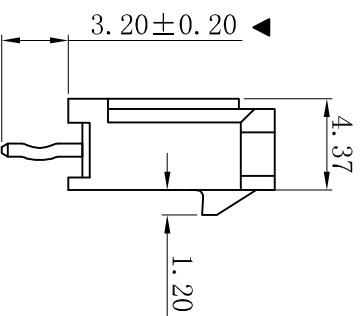
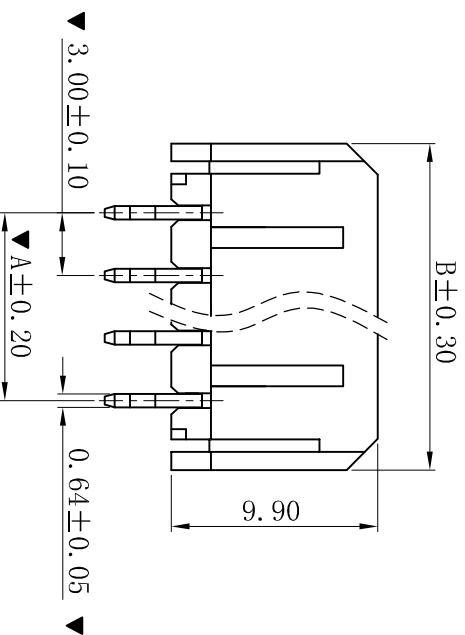
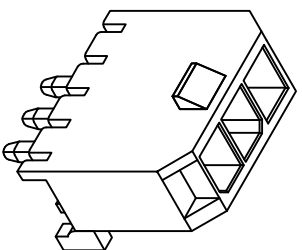

P.C.B. LAYOUT: TOP VIEW  
TOLERANCE: ±0.05mm

■ SPECIFICATIONS

- Voltage rating: 250V AC, DC
- Current rating: 5A, AC, DC
- Withstanding Voltage: 1500V AC/minute
- Insulation resistance: 1000MΩ min
- Temperature range: -25° C~+85° C
- Contact resistance: 20mΩ max

■ WAFER

- Part No. : W3045V-1XNP-B
- Poles : 02-12P
- Housing Material : PA66 15%GF UL94V-0 Black
- Pin Material : Brass
- Contact Area Plating: Tin-Plated
- The Dimension Marked “▼” Must Be Recorded

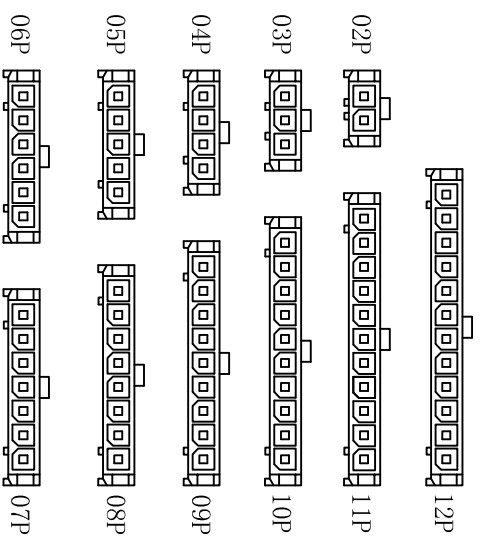

CIRCUIT SIZE LAYOUT

Poles	Dimensions(mm)	
	A	B
02	3.00	9.65
03	6.00	12.65
04	9.00	15.65
05	12.00	18.65
06	15.00	21.65
07	18.00	24.65
08	21.00	27.65
09	24.00	30.65
10	27.00	33.65
11	30.00	36.65
12	33.00	39.65

D	更新图面	2019-06-03	陈雄军
C	修訂版本	2015-11-04	陈雄军
B	变更图宽格式内容	2013-12-27	陈雄军
A	新版本	2011-05-24	陈雄军
H	说明	日期	承认
1	DESCRPTION	DATE	APPRO.

一般公差	0±0.30
GENERAL TOLERANCE:	.0±0.25
	.00±0.20
	.000±0.05
ANGLE: ±1°	

**XYZD® 东莞市祥运连接器有限公司**  
Dongguan XiangYun Connectors CO., Ltd

投影法 Projection	第一角投影
单位 Unit	MM
比例/Scale	1:1
大小/Size	A4
页码/SHEET	1/1
版本/Rev	D

品名 (PART NAME): Molex 3.00mm 180° 无柱子 Wafer Connector Series

料号 (PART NO): W3045V-1XNP-B

状态码: C