

ROHS

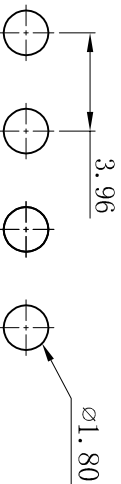
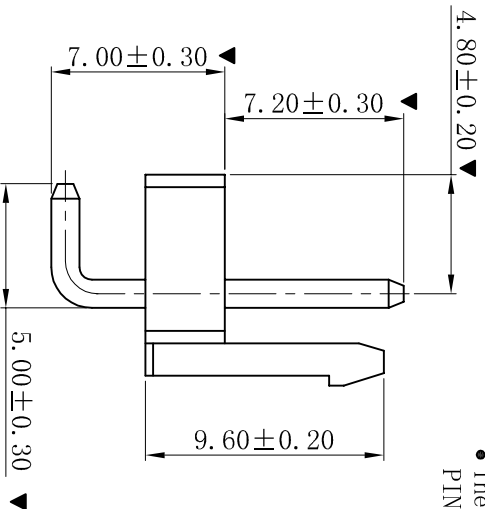
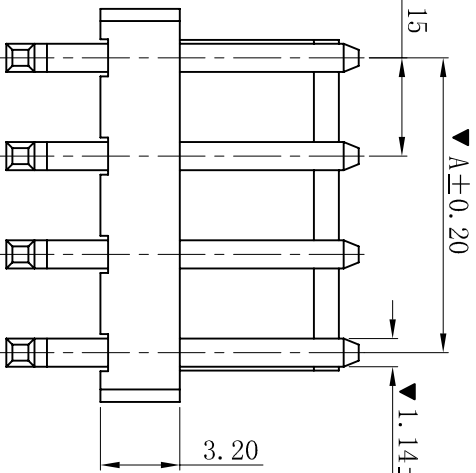
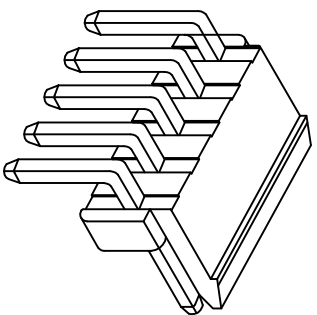
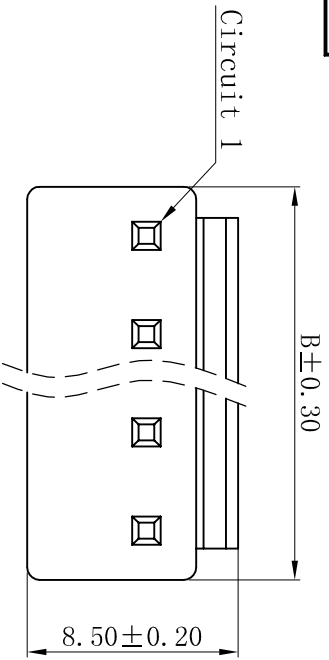

P. C. B. LAYOUT

■ SPECIFICATIONS

- Voltage rating: 250V AC, DC
- Current rating: 7A, AC, DC
- Withstanding Voltage: 1500V AC/minute
- Insulation resistance: 1000MΩ min
- Temperature range: -25° C~+85° C
- Contact resistance: 20mΩ max

■ WAFER

- Part No. : W3961R-NP-G1-S5. 0
- Poles : 02-16P
- Housing Material : PA66 UL94V-0
- Pin Material : Brass
- Contact Area Plating: Gold-Flash 1u" Min
- The Dimension Marked "▼" Must Be Recorded
PIN L=1.14x17.50mm

Poles	Dimensions(mm)	
	A	B
02	3.96	7.92
03	7.92	11.88
04	11.88	15.84
05	15.84	19.80
06	19.80	23.76
07	23.76	27.72
08	27.72	31.68
09	31.68	35.64
10	35.64	39.60
11	39.60	43.56
12	43.56	47.52
13	47.52	51.48
14	51.48	55.44
15	55.44	59.40
16	59.40	63.36

D	更新图面	2019-06-03	陈雄军	一般公差 GENERAL TOLERANCE: 0±0.30 .0±0.25 .00±0.20 .000±0.05 ANGLE: ±1°
C	修订版本	2015-11-04	陈雄军	绘图/DR 审核/CHECK 批准/APPRO
B	变更图宽格式内容	2013-12-27	陈雄军	日期/DATE
A	新版本	2011-05-24	陈雄军	日期/DATE
H	版次 REV.	1	说明 DESCRIPTION	日期/DATE

XYDZ® 东莞市祥运连接器有限公司
Dongguan XiangYun Connector's CO., Ltd

投影法
Projection
单位 Unit
MM

品名
(PART NAME)
VH 3.96mm 90° Wafer
Connector Series

料号
(PART NO)
W3961R-NP-G1-S5. 0

状态码
C