

RoHS

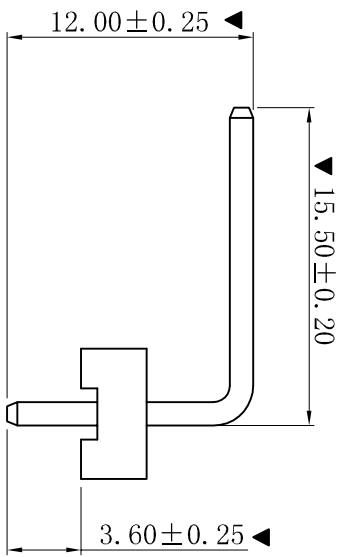
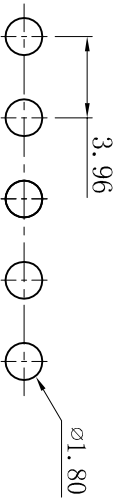
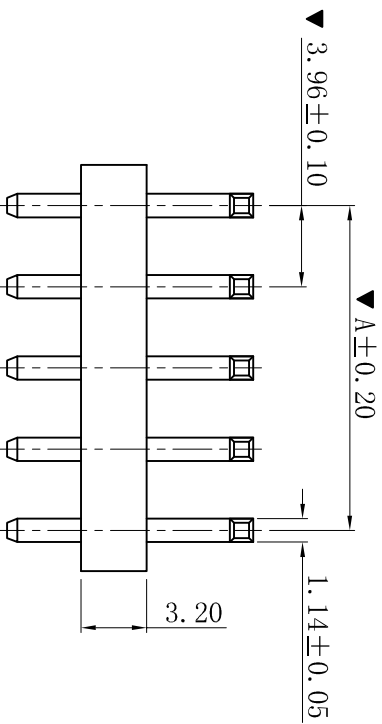
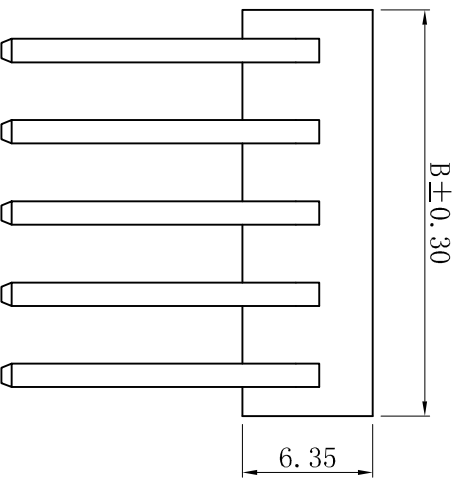

- SPECIFICATIONS**
- Voltage rating: 250V AC, DC
 - Current rating: 7A, AC, DC
 - Withstanding Voltage: 1500V AC/minute
 - Insulation resistance: 1000MΩ min
 - Temperature range: -25° C~+85° C
 - Contact resistance: 20mΩ max
- WAFER**
- Part No. : W3962WKBR-NP-S15.5-D3.6
 - Poles : 02-20P
 - Housing Material: PA66 UL94V-2
 - Pin Material: Brass
 - Contact Area Plating: Tin-Plated
 - PIN L=1.14x25.70
 - The Dimension Marked “▲” Must Be Recorded

Poles	Dimensions (mm)	
	A	B
02	3.96	7.92
03	7.92	11.88
04	11.88	15.84
05	15.84	19.80
06	19.80	23.76
07	23.76	27.72
08	27.72	31.68
09	31.68	35.64
10	35.64	39.60
11	39.60	43.56
12	43.56	47.52
13	47.52	51.48
14	51.48	55.44
15	55.44	59.40
16	59.40	63.36
17	63.36	67.32
18	67.32	71.28
19	71.28	75.24
20	75.24	79.20

P. C. B. LAYOUT

D	更新图面	2019-06-03	陈雄军
C	修订版本	2015-11-04	陈雄军
B	变更图宽格式内容	2013-12-27	陈雄军
A	新版本	2011-05-24	陈雄军
H	说明	日期	承认
1	DESCRPTION	DATE	APPRO.

一般公差		0±0.30
GENERAL TOLERANCE:		.0±0.25
		.00±0.20
		.000±0.05
ANGLE: ±1°		
绘图/DR	陈雄军	2019-06-03
审核/CHECK	陈雄军	
核准/APPRO	胡进	
日期/DATE	2019-06-03	

XYDZ® 东莞市祥运连接器有限公司
Dongguan XiangYun Connectors CO., Ltd

投影法 Projection	第一角
单位 Unit	MM
比例/Scale	1:1
大小/SIZE	A4
页码/SHEET	1/1
版本/Rev	D

品名 (PART NAME)	Mollex 3.96mm 90° 无靠背 Wafer Connector Series
料号 (PART NO)	W3962WKBR-NP-S15.5-D3.6
状态码	C