

RoHS

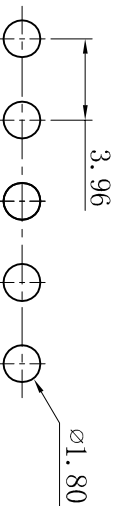
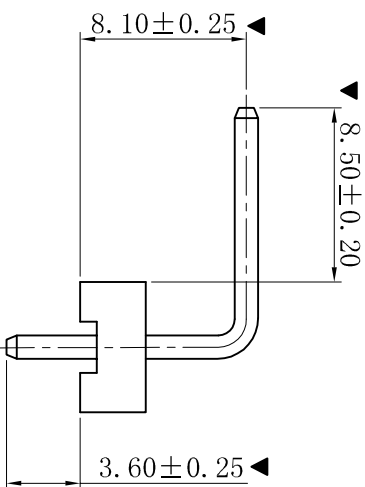
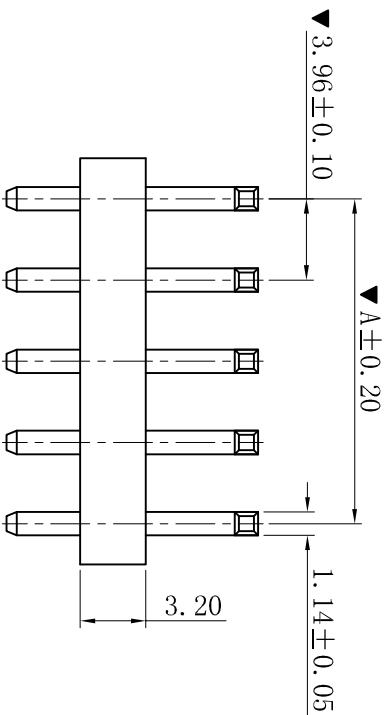
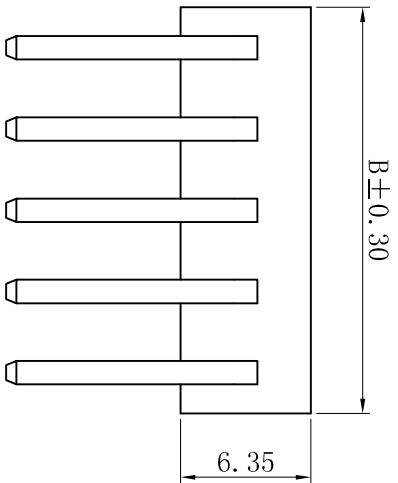

P.C.B. LAYOUT

- SPECIFICATIONS**
- Voltage rating: 250V AC, DC
 - Current rating: 7A, AC, DC
 - Withstanding Voltage: 1500V AC/minute
 - Insulation resistance: 1000MΩ min
 - Temperature range: -25° C ~ +85° C
 - Contact resistance: 20mΩ max
- WAFER**
- Part No.: W3962WKB-R-NP
 - Poles : 02-20P
 - Housing Material: PA66 UL94V-0
 - Pin Material: Brass
 - Contact Area Plating: Tin-Plated
 - The Dimension Marked “▼” Must Be Recorded

| Poles | Dimensions (mm) | |
|-------|-----------------|-------|
| | A | B |
| 02 | 3.96 | 7.92 |
| 03 | 7.92 | 11.88 |
| 04 | 11.88 | 15.84 |
| 05 | 15.84 | 19.80 |
| 06 | 19.80 | 23.76 |
| 07 | 23.76 | 27.72 |
| 08 | 27.72 | 31.68 |
| 09 | 31.68 | 35.64 |
| 10 | 35.64 | 39.60 |
| 11 | 39.60 | 43.56 |
| 12 | 43.56 | 47.52 |
| 13 | 47.52 | 51.48 |
| 14 | 51.48 | 55.44 |
| 15 | 55.44 | 59.40 |
| 16 | 59.40 | 63.36 |
| 17 | 63.36 | 67.32 |
| 18 | 67.32 | 71.28 |
| 19 | 71.28 | 75.24 |
| 20 | 75.24 | 79.20 |

| Poles | Dimensions (mm) | |
|-------|-----------------|-------|
| | A | B |
| 02 | 3.96 | 7.92 |
| 03 | 7.92 | 11.88 |
| 04 | 11.88 | 15.84 |
| 05 | 15.84 | 19.80 |
| 06 | 19.80 | 23.76 |
| 07 | 23.76 | 27.72 |
| 08 | 27.72 | 31.68 |
| 09 | 31.68 | 35.64 |
| 10 | 35.64 | 39.60 |
| 11 | 39.60 | 43.56 |
| 12 | 43.56 | 47.52 |
| 13 | 47.52 | 51.48 |
| 14 | 51.48 | 55.44 |
| 15 | 55.44 | 59.40 |
| 16 | 59.40 | 63.36 |
| 17 | 63.36 | 67.32 |
| 18 | 67.32 | 71.28 |
| 19 | 71.28 | 75.24 |
| 20 | 75.24 | 79.20 |

| | | | | | | | | | | |
|------|-------------|------------|--------|-------------|------------|--------|------|------------|------|------|
| D | 更新图面 | 2019-06-03 | 陈雄军 | 更新图面 | 2019-06-03 | 陈雄军 | 胡进 | 2019-06-03 | 胡进 | 胡进 |
| C | 修订版本 | 2015-11-04 | 陈雄军 | 变更图宽格式内容 | 2013-12-27 | 陈雄军 | 胡进 | 2019-06-03 | 胡进 | 胡进 |
| B | 新版本 | 2011-05-24 | 陈雄军 | 说明 | | 陈雄军 | 胡进 | 2019-06-03 | 胡进 | 胡进 |
| A | 版次 | | 承认 | 说明 | | 陈雄军 | 胡进 | 2019-06-03 | 胡进 | 胡进 |
| REV. | DESCRIPTION | DATE | APPRO. | DESCRIPTION | DATE | APPRO. | DATE | DATE | DATE | DATE |

| | | | | | |
|--|--|-------------------------------|---|-------------------------|------------|
| <p>XYDZ® 东莞市祥运连接器有限公司 Dongguan XiangYun Connectors CO., Ltd</p> | | <p>投影法 Projection</p> | <p>品名 (PART NAME)</p> | <p>料号 (PART NO)</p> | <p>状态码</p> |
| <p>Connectors</p> | | <p>单位 Unit MM</p> | <p>Mollex 3.96mm 90° 无靠背 Wafer Connector Series</p> | <p>W3962WKB-R-NP</p> | <p>C</p> |
| <p>一般公差 GENERAL TOLERANCE:</p> | | <p>比例/Scale 1:1</p> | | | |
| <p>0±0.30 .0±0.25 .00±0.20 .000±0.05 ANGLE: ±1°</p> | | <p>大小/Size A4 1/1</p> | | | |
| <p>绘图/DR 审核/CHECK 批准/APPRO</p> | | <p>页码/SHEET D</p> | | | |
| <p>陈雄军 陈雄军 胡进</p> | | | | | |