

ROHS

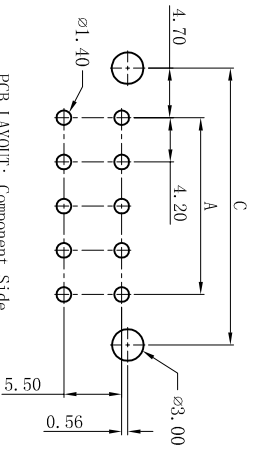
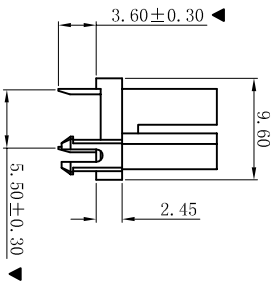
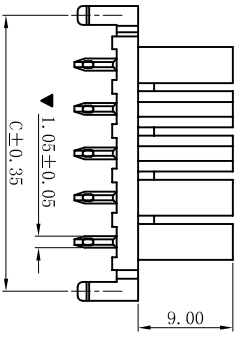
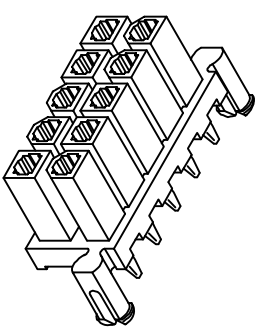
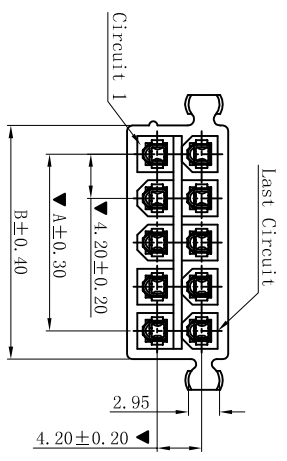

PCB LAYOUT: Component Side  
Recommended PCB Thickness 1.78MMX

W4201VTD-2xNP-X X

HSG Material / COLOR  
None: PA66-V0 Natural  
V0BK: PA66-V0 Black  
V2: PA66-V2 Natural  
V2BK: PA66-V2 Black  
LP: ICP-V0 Natural  
LPBK: ICP-V0 Black  
9T: PA9T-V0 Natural  
9TBK: PA9T-V0 Black  
46: PA46-V0 Natural  
46BK: PA46-V0 Black

CONTACT FINISH  
None: Tin-plated  
Sw: Matte Tin-plated  
G: Gold-flash  
G3: 3u" Gold  
G10: 10u" Gold  
G15: 15u" Gold  
G30: 30u" Gold

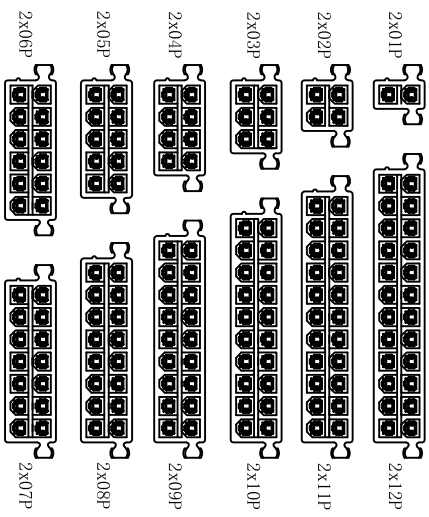

PART NO.	Dimensions (mm)		
	A	B	C
2x01	/	5.40	9.40
2x02	4.20	9.60	13.60
2x03	8.40	13.80	17.80
2x04	12.60	18.00	22.00
2x05	16.80	22.20	26.20
2x06	21.00	26.40	30.40
2x07	25.20	30.60	34.60
2x08	29.40	34.80	38.80
2x09	33.60	39.00	43.00
2x10	37.80	43.20	47.20
2x11	42.00	47.40	51.40
2x12	46.20	51.60	55.60

■ SPECIFICATIONS

- Voltage rating: 600V AC, DC
- Current rating: 7A, AC, DC
- Withstanding Voltage: 1500V AC/minute
- Insulation resistance: 1000MΩ min
- Temperature range: -25° C~+85° C
- Contact resistance: 20mΩ max

■ WAFER

- Part No.: W4201VTD-2xNP-XX
- Poles : 02-24P
- Housing Material: PA66 UL94V-0 or UL94V-2
- Pin Material: Phosphor Bronze
- Contact Area: Selective Gold or Matte Tin Plating Thickness Min;
- Soldering Area: Matte Tin 100u" Plating Thickness Min. Under Plating: Nickel Plating 50u"
- The Dimension Marked "▼" Must Be Recorded

D	更新图面	2019-07-03	陈雄军	承认	日期	2019-07-03
C	修订版本	2015-11-04	陈雄军	承认	日期	2015-11-04
B	变更图宽格式内容	2013-12-27	陈雄军	承认	日期	2013-12-27
A	新版本	2011-05-24	陈雄军	承认	日期	2011-05-24
H	说明					
1	版次					
2	REV.					
3	DESCRIPTION					
4	说明					
5	DESCRIPTION					

一般公差	0±0.30
GENERAL TOLERANCE:	.00±0.25
	.000±0.05
ANGLE:	±1°

**XYDZ® 东莞市祥运连接器有限公司**  
Dongguan XiangYun Connectors CO., Ltd

投影法  
单位 Unit: MM  
比例/Scale: 1:1  
大小/Size: A4  
页码/SHEET: 1/1  
版本/Rev: D

品名 (PART NAME): MoJex 4.20mm 180° 公座带柱 Wafer Connector Series  
料号 (PART NO): W4201VTD-2xNP-XX  
状态码: C

RoHS

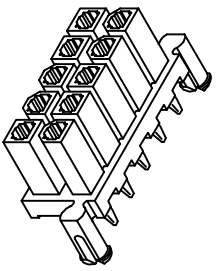

产品

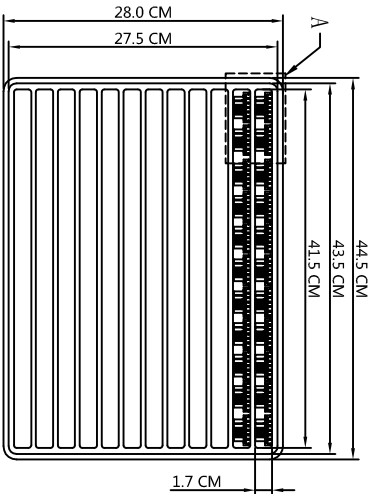

吸塑盘下盖(12格)

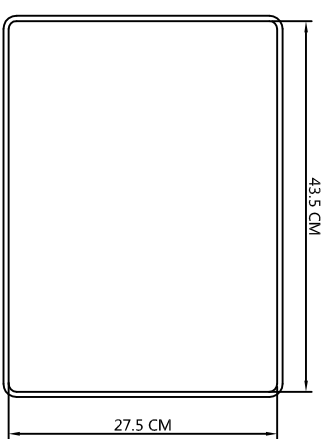
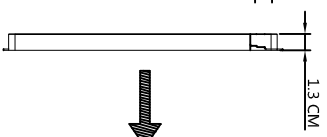

吸塑盘上盖

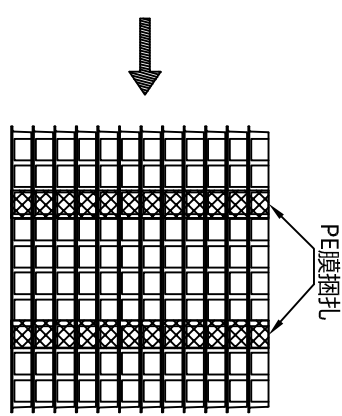

最上层盖—上盖

Pin/位	PCS/盘	层/箱	PCS/箱
2x1P	420	20	8400
2x2P	300	20	6000
2x3P	240	20	4800
2x4P	204	20	4080
2x5P	168	20	3360
2x6P	144	20	2880
2x7P	132	20	2640
2x8P	120	20	2400
2x9P	108	20	2160
2x10P	96	20	1920
2x11P	84	20	1680
2x12P	84	20	1680

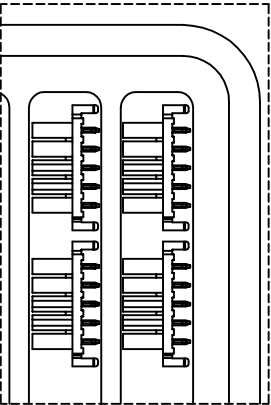

局部放大图A

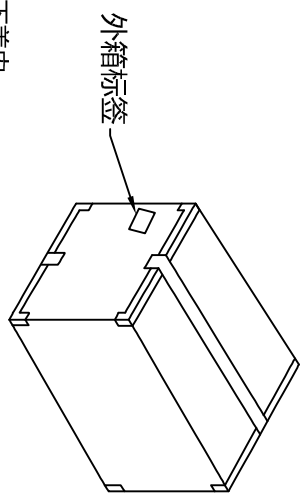

封箱(I字形)

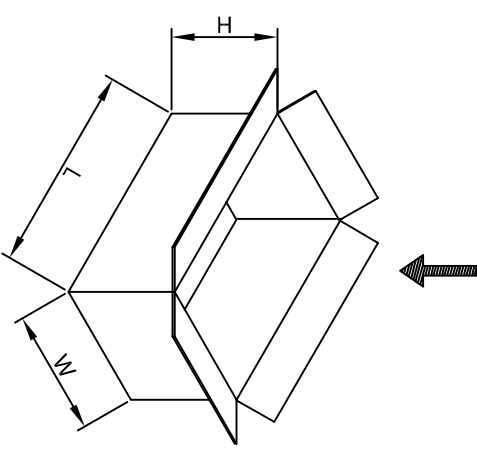

外箱规格:  
45.0(L)x29.0(W)x25.0(H)CM

**包装说明:**  
**步骤1:** 将产品按要求整齐摆放入吸塑盘下盖内.  
 在层叠起来,方向需一致.  
**步骤2:** 按一箱层叠20层叠起来,最上层盖—上盖.  
 然后用PE膜扎住为一箱,放入纸箱,封箱,贴外箱标签.  
**注:** 不满一箱时,需以填充物填充,不可有晃动.

Pin/位	PCS/盘	层/箱	PCS/箱
2x1P	420	20	8400
2x2P	300	20	6000
2x3P	240	20	4800
2x4P	204	20	4080
2x5P	168	20	3360
2x6P	144	20	2880
2x7P	132	20	2640
2x8P	120	20	2400
2x9P	108	20	2160
2x10P	96	20	1920
2x11P	84	20	1680
2x12P	84	20	1680

<p>一般公差 GENERAL TOLERANCE: 0±0.50 .0±0.40 .00±0.30 .000±0.10 ANGLE: ±1°</p>		<p>投影法 Projection 单位 Unit MM</p>		<p>品名 (PART NAME) Molex4.20mm 2xNP 180° 公座带柱 Packaging Specification</p>	
<p>绘图/DR 审核/CHECK 批准/APPRO</p>		<p>陈雄军 胡进</p>		<p>料号 (PART NO) W4201VTD-2xNP</p>	
<p>日期/DATE 2019-06-15</p>		<p>日期/DATE 2019-06-15</p>		<p>状态码 C</p>	
<p>说明 DESCRIPTION 新版本</p>		<p>承认 APPRO. PPA Duca</p>		<p>东莞市祥运连接器有限公司 Dongguan XiangYun Connector s CO., Ltd</p>	

Pin/位	PCS/盘	层/箱	PCS/箱
2x1P	420	20	8400
2x2P	300	20	6000
2x3P	240	20	4800
2x4P	204	20	4080
2x5P	168	20	3360
2x6P	144	20	2880
2x7P	132	20	2640
2x8P	120	20	2400
2x9P	108	20	2160
2x10P	96	20	1920
2x11P	84	20	1680
2x12P	84	20	1680