

RoHS

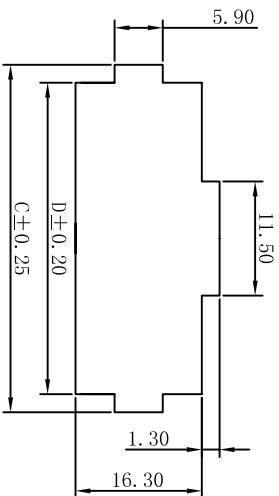
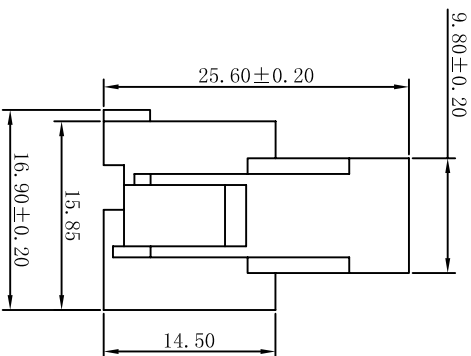
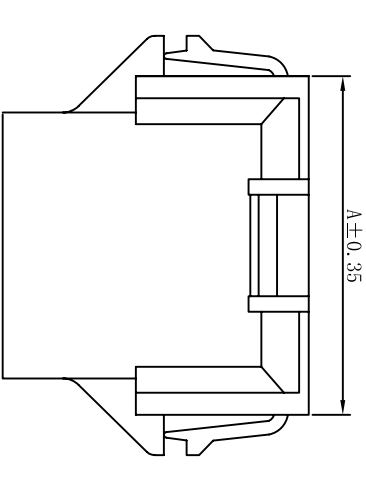
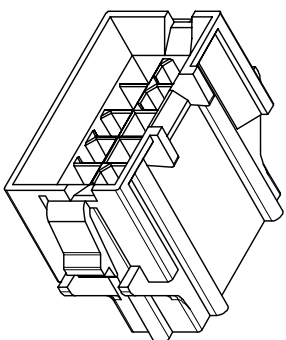
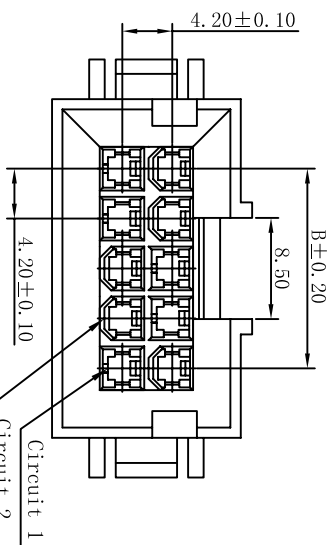

RECOMMENDED PCB CUTOUT
PANEL THICKNESS: 1.60

■ SPECIFICATIONS

- Voltage rating: 600V AC, DC
- Current rating: 7A, AC, DC
- Withstanding Voltage: 1500V AC/minute
- Insulation resistance: 1000MΩ min
- Temperature range: -25 °C ~ +85 °C
- Contact resistance: 20mΩ max

■ HOUSING

- Part No. : H4202L-2xNP-XX
- Poles: 04-36P
- Housing Material: Nylon66 UL94V-2 or UL94V-0
- Mates With: H4201L dual row receptacle
- Use With: T4201 terminals
- The Dimension Marked "▼" Must Be Recorded

H4202L-2xNP-XX

- None: Pa66-V2 Natural
- BK: Pa66-V2 Black
- V0: Pa66-V0 Natural
- VOBK: Pa66-V0 Black

Part No	Dimensions			
	A	B	C	D
2x02	15.80	4.20	19.80	16.30
2x03	20.00	8.40	24.00	20.50
2x04	24.20	12.60	28.20	24.70
2x05	28.40	16.80	32.40	28.90
2x07	36.80	25.20	40.80	37.30
2x09	45.20	33.60	49.20	45.70
2x10	49.40	37.80	53.40	49.90
2x12	57.80	46.20	61.80	58.30

XYDZ® 东莞市祥运连接器有限公司
Dongguan Xiangyun Connectors CO., Ltd

一般公差 GENERAL TOLERANCE:	0±0.30 .0±0.25 .00±0.20 .000±0.05
ANGLE: ±1°	

Connectors

投影法
Projection



单位 Unit
MM

比例/Scale
1:1

大小/SIZE
A4

页码/SHEET
1/1

品名
(PART NAME)

MX4.20mm Female Housing
Connector Series

料号
(PART NO)

H4202L-2xNP-XX

修订版本 REV.	说明 DESCRIPTION	日期 DATE	承认 APPRO.
C	变更图章格式内容	2013-12-27	陈雄军
B	新版本	2011-05-24	陈雄军
A			

1	2	3	4	5	6	7	8	9	10
---	---	---	---	---	---	---	---	---	----