

RoHS

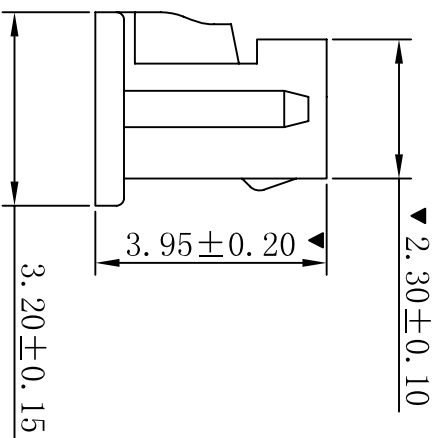
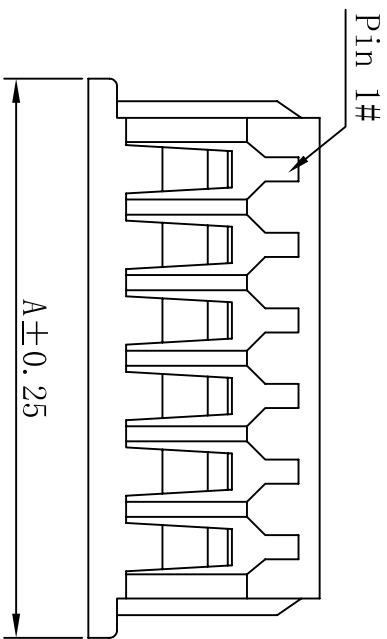
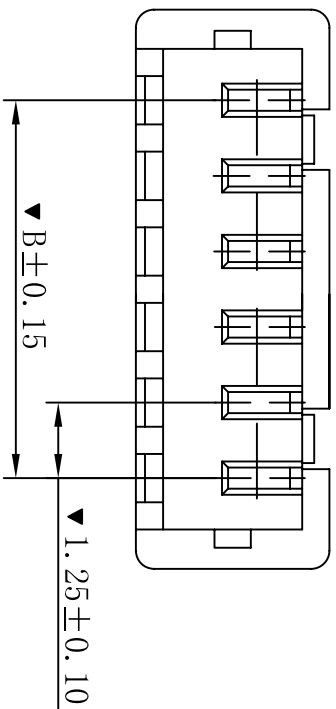

- SPECIFICATIONS
- Voltage rating: 125V AC, DC
 - Current rating: 1A, AC, DC
 - Withstanding Voltage: 250V AC/minute
 - Insulation resistance: 100MΩ min
 - Temperature range: -25 °C ~ +85 °C
 - Contact resistance: 20mΩ max
- HOUSING
- Part No.: H1250-NP
 - Poles: 02-15P
 - Housing Material: Nylon66 UL94V-0
 - The Dimension Marked “▼” Must Be Recorded

Contacts	Dimensions(mm)	
	Dim A	Dim B
02	4.25	1.25
03	5.50	2.50
04	6.75	3.75
05	8.00	5.00
06	9.25	6.25
07	10.50	7.50
08	11.75	8.75
09	13.00	10.00
10	14.25	11.25
11	15.50	12.50
12	16.75	13.75
13	18.00	15.00
14	19.25	16.25
15	20.50	17.50

修订版本		2015-11-04	陈雄军	一般公差 GENERAL TOLERANCE:		0±0.30 .0±0.25 .00±0.20 .000±0.05
变更图章格式内容		2013-12-27	陈雄军	绘图/DR		ANGLE: ±1°
新版本		2011-05-24	陈雄军	审核/CHECK	胡进	
说明		日期	承认	批准/APPRO	MR. feng	
DESCRIPTION		DATE	APPRO.	日期/DATE	2015-12-24	

<p>XYDZ® 东莞市祥运连接器有限公司 Dongguan XiangYun Connectors CO., Ltd</p>		投影法 Projection	品名 (PART NAME)	MX1.25mm Male Housing
		单位 Unit	料号 (PART NO)	H1250-NP
		比例/Scale		
		大小/SIZE		
		页码/SHEET		
		版本/Rev		

ROHS

- SPECIFICATIONS
- Voltage rating: 125V AC, DC
 - Current rating: 1A, AC, DC
 - Withstanding Voltage: 250V AC/minute
 - Insulation resistance: 100MΩ min
 - Temperature range: -25°C~+85°C
 - Contact resistance: 20mΩ max
- TERMINAL
- Part No.: T1250PT
 - Applicable wire: AWG#28-#32
 - Material: Phosphor Bronze
 - Finish: Tin plated
 - The Dimension Marked “▼” Must Be Recorded

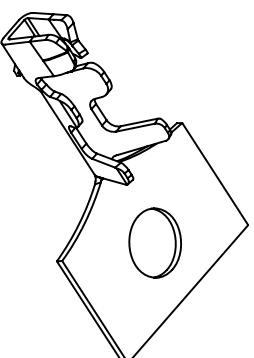
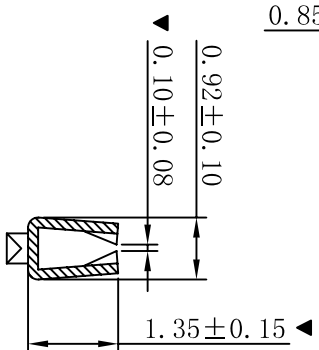
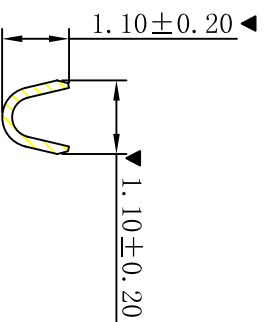
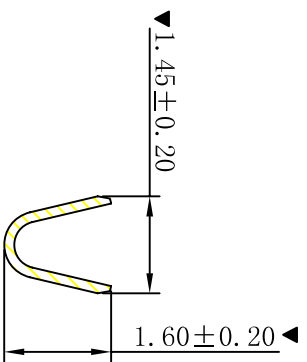
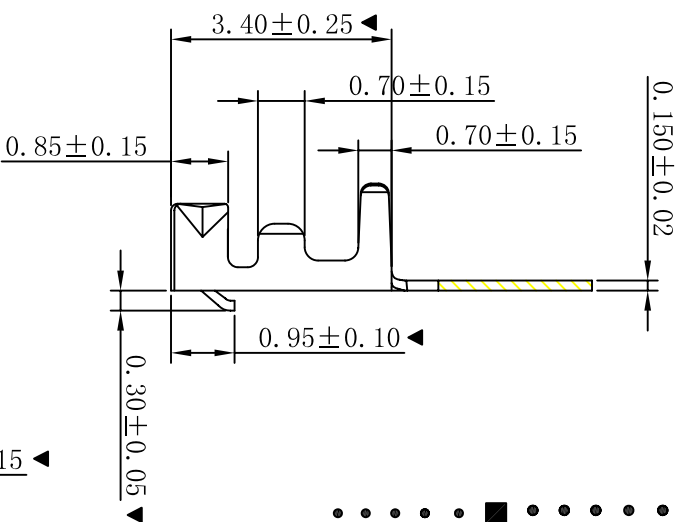
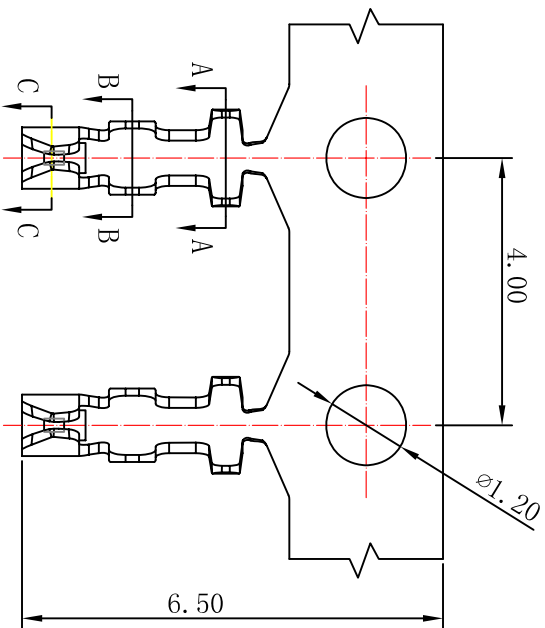

XYDZ® 东莞市祥运连接器有限公司
 Dongguan Xiangyun Connectors CO., Ltd

一般公差 GENERAL TOLERANCE:	0±0.30 .0±0.25 .00±0.20 .000±0.05
绘图/DR	陈雄军
审核/CHECK	胡进
日期/DATE	2016-12-14

投影法
Projection

单位 Unit
MM

比例/Scale
1:1

大小/SIZE
A4

页码/SHEET
1/1

品名
(PART NAME)
MX1.25mm Female Terminal
Connector Series

料号
(PART NO)
T1250PT

修订版本
2015-11-04
陈雄军

变更图章格式内容
2013-12-27
陈雄军

新版本
2011-05-24
陈雄军

说明
2011-05-24
陈雄军

版次
REV.
1

日期/DATE	2016-12-14
承认 APPRO.	陈雄军
日期/DATE	2016-12-14
承认 APPRO.	陈雄军

日期/DATE

承认 APPRO.

日期/DATE

承认 APPRO.

日期/DATE

1 2 3 4 5 6 7 8 9 10

ROHS

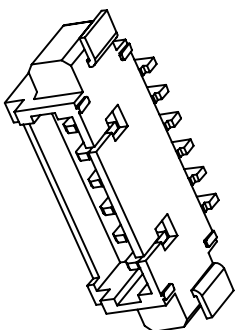
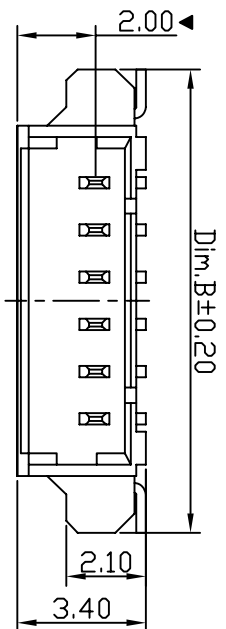

■ SPECIFICATIONS

- Voltage Rating: 125V AC, DC
- Current Rating: 1.0A, AC, DC
- Withstanding Voltage: 250V AC/minute
- Insulation Resistance: 100MΩ min
- Temperature range: -25° C ~ +85° C
- Contact resistance: 20mΩ max

■ WAFER

- Part No. : W1251SR-NP
- Poles : 02-15P
- Material : Nylon 46 UL94V-0
- Pin Material : Phosphor Bronze /Tin-plated
- Solder Tab Material : Brass /Tin-plated
- The Dimension Marked "▲" Must Be Recorded

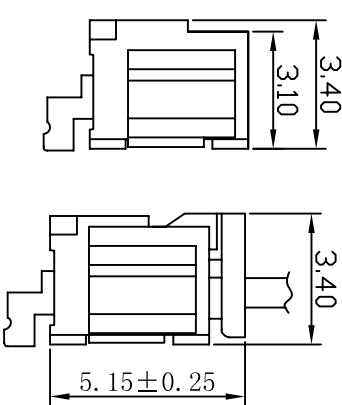
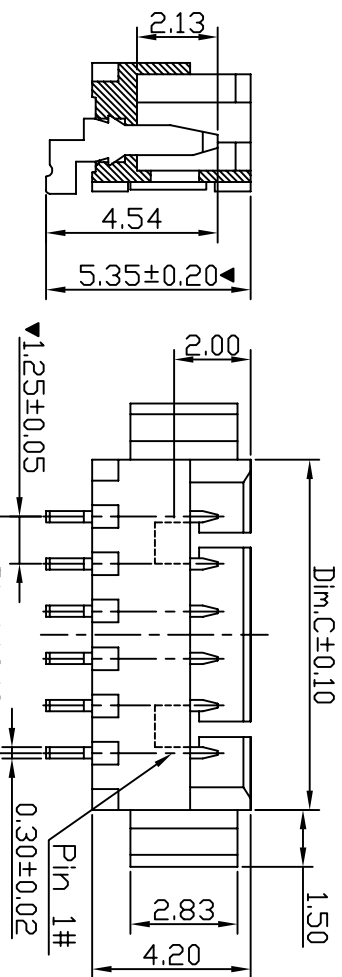

Matching Height Drawing

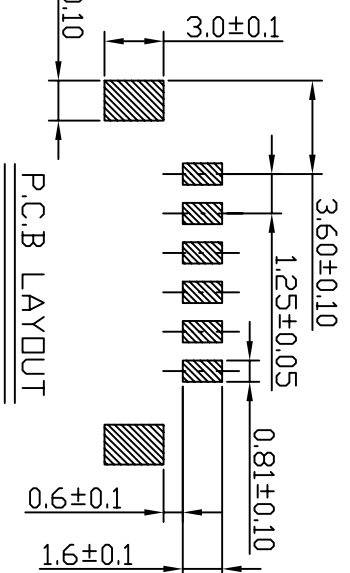
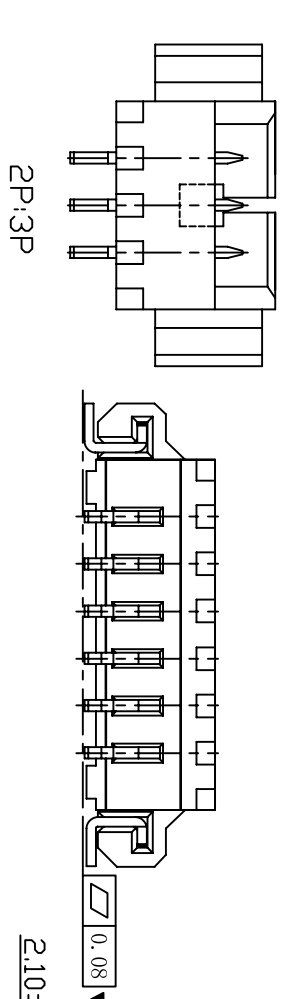

Contacts	Dimensions(mm)		
	Dim A	Dim B	Dim C
02	1.25	7.25	4.25
03	2.50	8.50	5.50
04	3.75	9.75	6.75
05	5.00	11.00	8.00
06	6.25	12.25	9.25
07	7.50	13.50	10.50
08	8.75	14.75	11.75
09	10.00	16.00	13.00
10	11.25	17.25	14.25
11	12.50	18.50	15.50
12	13.75	19.75	16.75
13	15.00	21.00	18.00
14	16.25	22.25	19.25
15	17.50	23.50	20.50

修订版本		2015-11-04		陈雄军		一般公差 GENERAL TOLERANCE:		0±0.20 .0±0.13 .00±0.08 .000±0.02		投影法 Projection		品名 (PART NAME)		MX1.25mm SMT 90° Wafer	
变更图章格式内容		2013-12-27		陈雄军		ANGLE: ±1°		.000±0.02		单位 Unit		Connector Series		W1251SR-NP	
新版本		2011-05-24		陈雄军		DRAWING		.000±0.02		比例/Scale		1:1			
说明		2011-05-24		陈雄军		APPRO.		MR. feng		大小/SIZE		A4			
DESCRIPTION		2011-05-24		陈雄军		DATE		2015-11-04		页码/SHEET		1/1			
版次		2011-05-24		陈雄军		APPRO.		2015-11-04		版本/Rev		C			
REV.		2011-05-24		陈雄军		APPRO.		2015-11-04		版本/Rev		C			

XYDZ® 东莞市祥运连接器有限公司
Dongguan Xiangyun Connector's CO., Ltd

ROHS

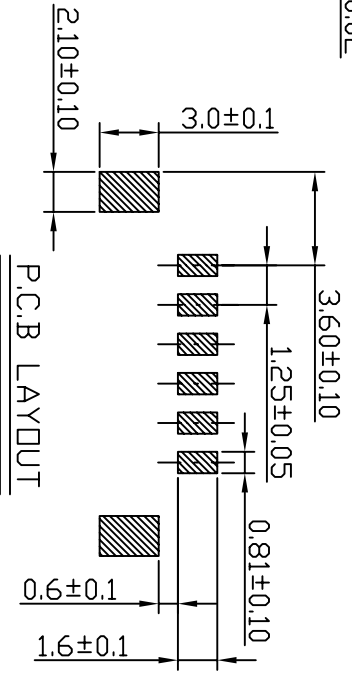
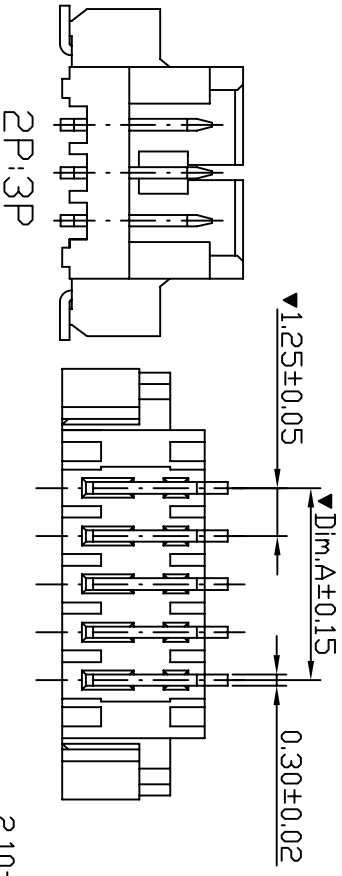
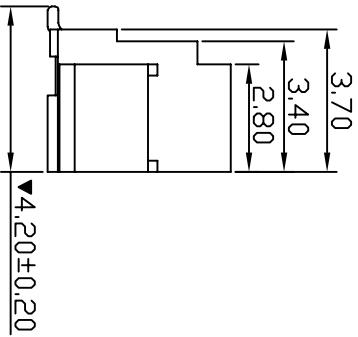
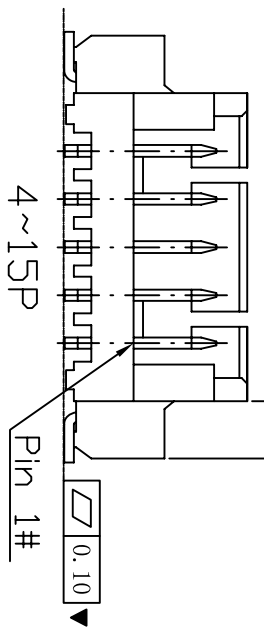
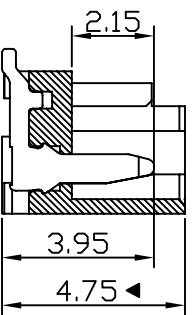
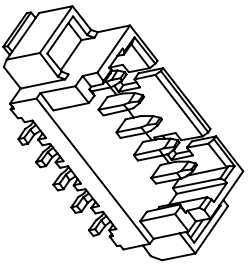
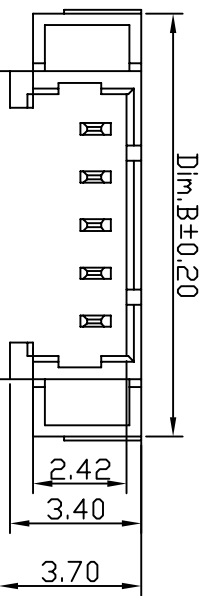

■ SPECIFICATIONS

- Voltage Rating: 125V AC, DC
- Current Rating: 1.0A, AC, DC
- Withstanding Voltage: 250V AC/minute
- Insulation Resistance: 100MΩ min
- Temperature range: -25°C ~ +85°C
- Contact resistance: 20mΩ max

■ WAFER

- Part No. : W1251SV-NP
- Poles : 02-15P
- Material : Nylon 46 UL94V-0
- Pin Material : Phosphor Bronze /Tin-plated
- Solder Tab Material : Brass /Tin-plated
- The Dimension Marked "▼" Must Be Recorded

Contacts	Dimensions(mm)		
	Dim A	Dim B	Dim C
02	1.25	7.25	4.25
03	2.50	8.50	5.50
04	3.75	9.75	6.75
05	5.00	11.00	8.00
06	6.25	12.25	9.25
07	7.50	13.50	10.50
08	8.75	14.75	11.75
09	10.00	16.00	13.00
10	11.25	17.25	14.25
11	12.50	18.50	15.50
12	13.75	19.75	16.75
13	15.00	21.00	18.00
14	16.25	22.25	19.25
15	17.50	23.50	20.50

XYDZ® 东莞市祥运连接器有限公司
 Dongguan Xiangyun Connectors CO., Ltd

一般公差 GENERAL TOLERANCE:	0±0.20 .0±0.13 .00±0.08 .000±0.02
绘图/DR	陈雄军
审核/CHECK	胡进
日期/DATE	2015-11-04

投影法
Projection



品名 (PART NAME) MX1.25mm SMT 180° Wafer
 料号 (PART NO) W1251SV-NP

修订版本	2015-11-04	陈雄军	承认
变更图章格式内容	2013-12-27	陈雄军	
新版本	2011-05-24	陈雄军	
说明	日期	日期	日期
DESCRIPTION	DATE	DATE	DATE