

ROHS

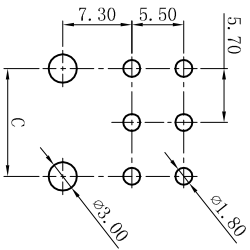

- SPECIFICATIONS
- Voltage rating: 600V AC, DC
 - Current rating: 23A, AC, DC
 - Withstanding Voltage: 2200V AC/minute
 - Insulation resistance: 1000M Ω min
 - Temperature range: -40 $^{\circ}$ C +105 $^{\circ}$ C
 - Contact resistance: 20m Ω max
- WAFER
- Part No. : W5701R-2xNP
 - Poles : 02-12P
 - Housing Material: LCP UL94V-0 Black
 - Pin Material: High Contactivity Copper Alloy
 - Contact Area Plating: Tin-Plated
 - The Dimension Marked “▼” Must Be Recorded

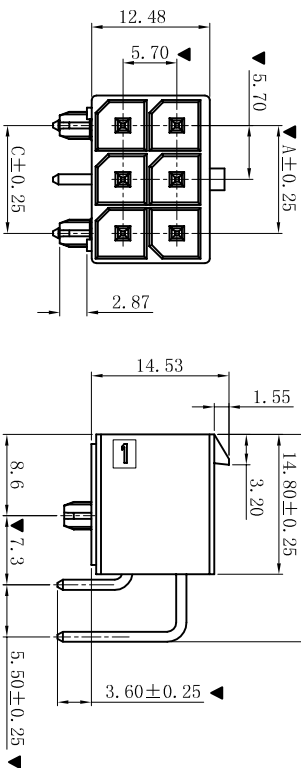
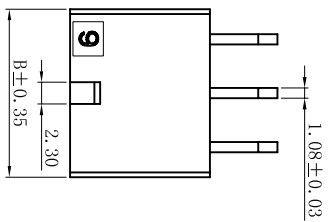
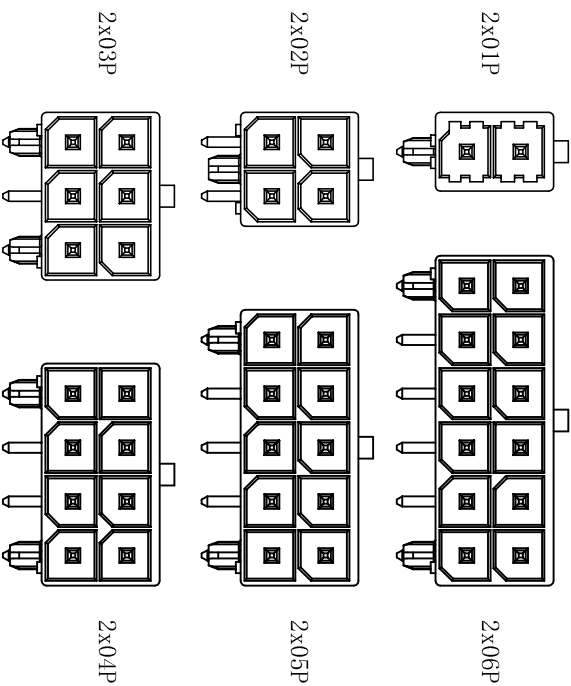

Poles	Dimensions (mm)		
	A	B	C
2x01	N/A	8.35	N/A
2x02	5.70	12.05	N/A
2x03	11.40	17.75	11.40
2x04	17.10	23.45	17.10
2x05	22.80	29.15	22.80
2x06	28.50	34.85	28.50

CIRCUIT SIZE LAYOUT

一般公差
GENERAL TOLERANCE:
0.0 ± 0.25
.00 ± 0.20
.000 ± 0.05
ANGLE. ± 1 $^{\circ}$

XYDZ[®] 东莞市祥运连接器有限公司
DongGuan XiangYun Connector s CO., Ltd

投影法: 单位 Unit: MM (PART NAME) Molex5.70mm 90 $^{\circ}$ Wafer Connector Series

审核/CHECK: 陈雄军 比例/Scale: 1:1 (PART NO) W5701R-2xNP
日期/DATE: 2022-05-10 胡进 页码/SHEET: 1/1 料号 (PART NO) W5701R-2xNP
日期/DATE: 2022-05-10 承认 APPRO. 版本/Rev: A 状态码 C

版次 REV.	A	新版本	2022-05-10	承认	日期	说明
DESCRIPTION	新版本					

1 2 3 4 5 6 7 8 9 10