

ROHS

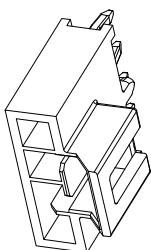
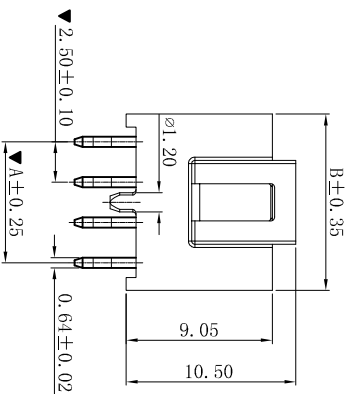
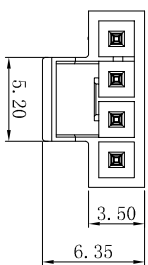
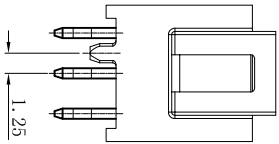
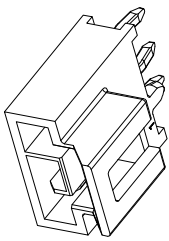

A: A Key (Black Plastic)
B: B Key (Nature Plastic)

Part No:
W2520V-1xNP-X

■ SPECIFICATIONS

- Voltage rating: 250V AC, DC
- Current rating: 4A, AC, DC
- Withstanding Voltage: 1500V AC/minute
- Insulation resistance: 1000MΩ min
- Temperature range: -25°C~+105°C
- Contact resistance: 20mΩ max

■ WAFER

- Part No. : W2520V-1xNP-X
- Poles: 02-8P

- Housing Material: LCP UL94V-0
- Pin Material: Brass
- Contact Area Plating: Tin-Plated
- The Dimension Marked “▼” Must Be Recorded

Dimensional Information (mm)

Poles	Dim. A	Dim. B
02P~08P	2.50xNP-2.5	2.50xNP+0.94

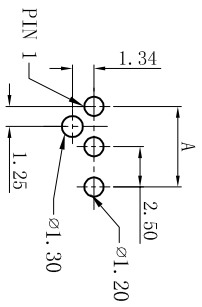

Only For CKT 3, 5, 7

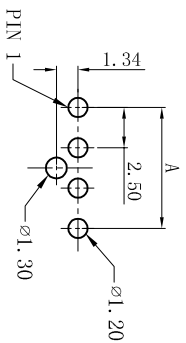

Recommended P. C. B
Thickness 1.6~2.4mm

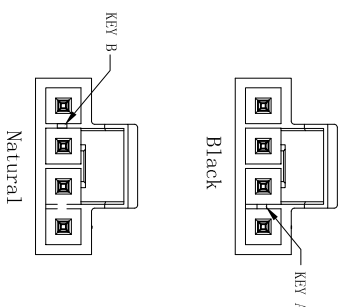

W2520V-1xNP-A A Key Color: Black	02 Poles	03 Poles	04 Poles	5 Poles

W2520V-1xNP-B B Key Color: Natural	6 Poles	7 Poles	8 Poles

W2520V-1xNP-A A Key Color: Black	6 Poles	7 Poles	8 Poles

W2520V-1xNP-B B Key Color: Natural	6 Poles	7 Poles	8 Poles

XYDZ® 东莞市祥运连接器有限公司
Dongguan XiangYun Connectors CO., Ltd

Connectors

MoLEX 2.50mm 1xNP 180°
Wafer Connector Series

料号 (PART NO) W2520V-1xNP-X
状态码 C

一般公差 GENERAL TOLERANCE:	.0±0.40 .00±0.25 .000±0.15
角度 ANGLE:	±5°

绘图/DR *PZL Data*

审核/CHECK 陈雄军

批准/APPRO 胡进

日期/DATE 2023-06-01

承认/APPRO *PZL Data*

日期/DATE 2023-06-01

说明 DESCRIPTION	新版本
版次 REV.	A

1 2 3 4 5 6 7 8 9 10